

what  
i need  
to know  
about  
locks &  
latches.

One thing we have found at Stonebridge is that many manufacturers of locks and latches make highly detailed technical drawings of their products and assume that because the information is there, that everyone understands it.

We understand that our customers are not experts in the field of hardware and terms such as deadlock and backsets might not mean too much. So we have put this guide together to try and explain the process of choosing a lock or latch without going into too much detail.

# what size of lock do i need.

Tubular latches, sash locks, deadlocks and bathroom locks are available in varying lengths and sizes to suit your requirements or match existing ones already fitted to your doors.

We are often asked "what size latches or locks do I need". When buying new door handles we always recommend changing the internal latches or locks for the following reasons.

Firstly they have probably become worn and could fail when the newer handles are fitted. The internal springs and follower (square hole where the bar goes through) will fatigue and eventually snap potentially stopping the door from being opened.

Secondly the latches might have a different throw (the distance the lock needs to travel) which will put increasing strain on the springs inside the handle and prematurely wearing them out.

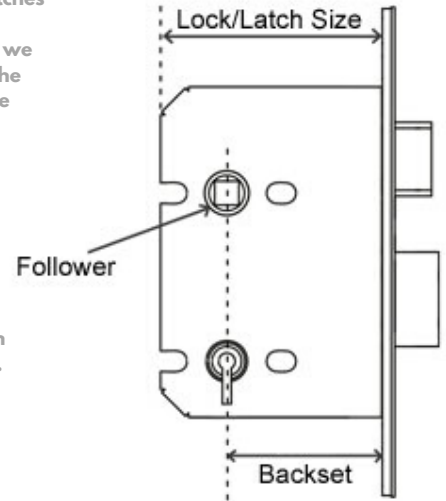

## backset.

The backset is the measurement from the edge of your door and the centre of the keyhole or follower. Make sure the lock or latch clears the frame stop gap (the distance between the edge of the door and the frame). Knuckles ! - there must be room for the hand to operate the door furniture without interference from the frame stop, especially important when fitting door knobs.

## sizes.

Often confused with backset, the size is the dimension of the lock or latch case which goes fully into the door, this will determine where your door handle or door knob will end up on your door, so if you a panelled door and you want your door furniture to sit nicely in the centre of the stile, or you have deep frame stops, you need to choose the correct size lock or latch with the correct backset to accommodate this.

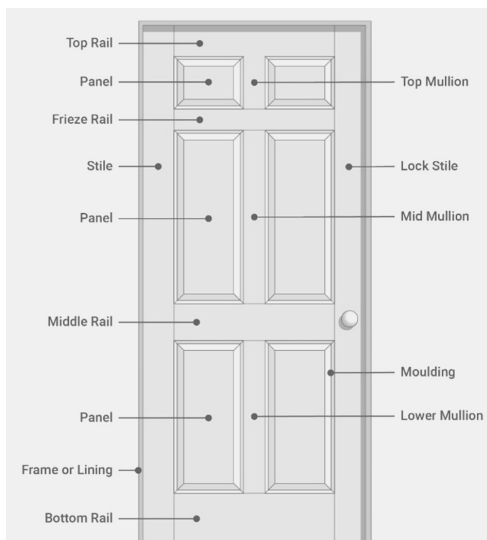

Below is a list of current metric backsets on locks and latches, a handy starting point to help you choose what you require.

Lock / Latch Size	Backset
64mm / 2.5"	45mm
76mm / 3"	57mm
102mm / 4"	82mm
127mm / 5" #	109mm
152mm / 6" #	134mm

## tip.

Make a paper template of the back plate that the door knob or lever comes on and lay it on the stile of the door, you will be able to see the scale of what it looks like and the position.

Glass doors will restrict the size and backset of your lock or latch so refer to your door handle / knob dimensions to make sure you have ample room to fit the plate and there is room for your hand to operate it.

# non stock items.

It might look like a minefield when you see how many locks and latch variations there are to choose from.

The choices are there for a reason to make sure every option of door security and functionality is covered for today's home.

We have tried to cover each lock and latch in a way that makes sense of why you need it, or if you need it.

All of our locks are chosen due to the quality and the testing of their function and longevity, all come with a manufacturers guarantee.

## what type of lock do i need.

Try not to make the mistake of fitting quality hardware to poor quality locks and latches, it really is a false economy especially if you end up refitting due to poor functionality, fitters costs are not cheap so do things once.

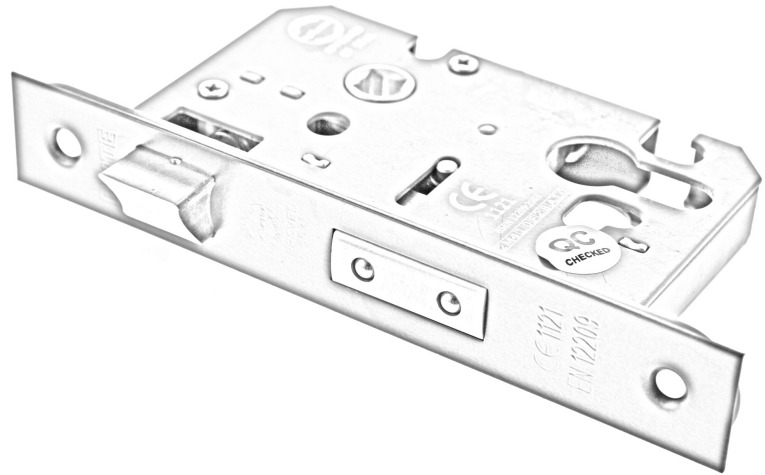

## tubular latch.



The tubular latch is most commonly used on interior doors around your home for door that don't require locking, they are relatively easy to fit and cost effective, they take an 8mm spindle.

They come supplied with a strike plate and cover plate along with fixings and dust box.



COVER PLATE

STRIKE PLATE

The cover plate is used on the door edge and the strike plate on the frame, all are available in Black, Satin Steel or Distressed Silver to match our full range of door hardware finishes.

We stock 2.5" / 3" / 4" versions of these latches which are suitable for all door hardware on roses or latch plates.

Dust boxes come with all of locks and latches, these are fitted to the frame behind the Strike plate to cover any unsightly chisel marks from fitting.

## tubular deadbolt.

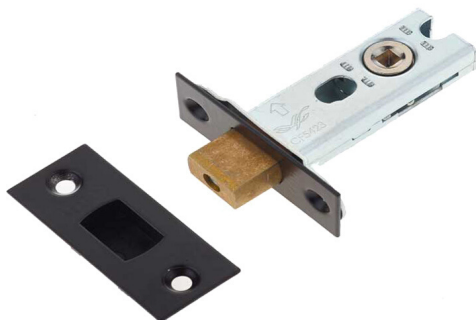

Tubular deadbolts are available in the same sizes as our Tubular Latches 2.5" / 3" / 4", they are fitted in the same way as a tubular latch.

They are used in conjunction with a thumb turn & release which can be used a separate set or integrated into a bathroom plate.

Unlike the tubular latch they have a 5mm square follower that accepts a 5mm spindle which comes with our hardware.

Mostly used on bathroom doors and thrown by a thumbturn on the inside of the door but can be opened by a coin release on the outside in case of emergencies.

# bathroom mortice lock.



A bathroom lock combines a latch and a deadbolt within the same lock case, it works exactly like have a tubular latch and a deadbolt in your door but it's fitted in one go.

It has the 8mm follower for the door furniture spindle and the 5mm follower for the turn and release.

We recommend using this type of lock where the turn and release are part of the same back plate on your hardware, when using a separate lever or door knob on a rose we would suggest using the tubular deadbolt which will provide more space underneath for operating.

Bathroom locks are available in 2.5" / 3" versions and come complete with strike plates / cover plates / dust box and fixings.

This range of Mortice Sash Locks are designed to accept a range of Euro shaped cylinders. This allows the user a greater degree of security and provides options for additional features such as master keying or keying alike. We supply locks and cylinders separately not together in order for you to measure what thickness door you have which will determine what length cylinder you will need. It also provides greater flexibility if you are installing the case into an unusual depth door, or require a different type of cylinder such as a half cylinder. These sash locks require a lever handle to operate the latch, whilst the deadlock element is operated via use of the key in the cylinder.

These locks have become popular due to the fact you can have one key to lock and open a number of different doors throughout your house, doors into garage, outbuildings that connect from the house, studio's in your garden and so on.

# euro sash lock.



# cylinders.

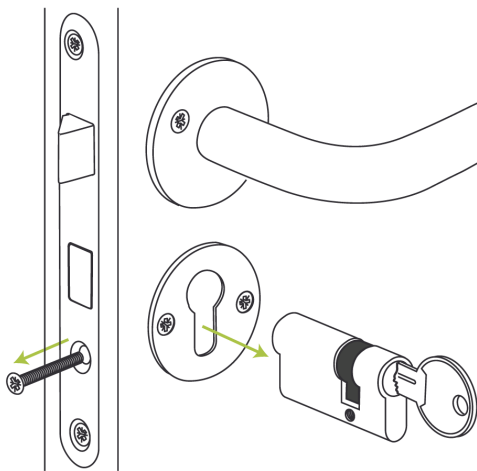

Working out what length cylinder you require just means you have to do a bit of measuring, the dimensions below will tell you the length you require, choose the nearest available length that gives you a minimal amount of cylinder proud of the escutcheon or back plate.

**Thickness of your door + thickness of escutcheon or back plate either side of the door.**

If you just need a key or thumbturn on the inside then half the door thickness.



Double cylinder where the lock can be used by a key from both sides available in black and satin chrome.

Key and thumbturn cylinder operated by a key on the outside and a thumbturn on the inside used on patio and entrance doors.



Half cylinders are used when you require locking from one side of the door.

All our cylinders are compatible with our Euro lock selection.

# deadlock.



3 lever locks are generally fitted internally as insurance rated locks are not generally required in private domestic properties. For example you would usually fit 3 Lever locks in the door leading from your house into a garage, or if you wish to pop a lock on a bedroom door for extra privacy then 3 Lever locks will suffice. All locks are usually supplied with a couple of keys as standard.

5 lever locks are commonly used on external back doors. It is because they are more secure, and they offer a better defence against breaking. External front doors also prefer these kinds of locks. Again, this is for the security you get from the locks. Some internal doors do not commonly use 5 lever mortice locks. It makes sense because you do not need such a high level of security for your internal locks.



Euro Deadlocks don't require a handle of any sort to facilitate operation as they are purely for use to secure the door. The bolt is operated via the key and cylinder, and can only be locked or unlocked this way.

A Night Latch (Yale Lock) is a lock commonly found on home front doors; they are mounted to doors that open inwards and mounted to the inner surface of the door. When the door is closed the night latch automatically latches the door shut. The door can be kept from latching closed by keeping the door 'on the latch', a phrase you may have heard of. Night Latches are very simple security they are very easy to use, open the door with a key and shut the door behind you. Also known as: you may also find a Night latch sometimes referred to as a 'Yale Lock' or 'Rim lock'.

# night latch.



# multipoint locks.



These days, multipoint locking is taking precedence over the traditional single-point locking of deadlocks and sashlocks, moving into the wooden, composite and even metal door market and not just on uPVC doors like it has been in the past. Historically, multipoint locks were designed for uPVC doors because quite simply, these plastic doors did not have the strength to rely on a single point of locking, and if you did just have a single locking point on a plastic door, then it would be possible for a burglar to bend / twist the door enough to facilitate their entry into the property. So the solution was to create multiple locking points at the top and bottom of the door, rather than just in the centre, emulating the well known security benefits of having separate deadlocks fitted at the top and bottom of wooden doors back in the days of having the old traditional Yale lock on your front door.

We would love to tell you we are experts on multipoint locks but this is the one area we tend to leave to specialized suppliers who pride themselves in knowing exactly what type of lock you require, all our door furniture is compatible with the leading manufacturers of this style of lock, our cylinders are suitable to be used with them also.